



RAVEN  
Concealment Systems

For more information or questions on the use of the VG2 go to: [rcsgear.com](http://rcsgear.com)



MADE IN THE U.S.

With U.S. Materials  
On U.S. Tooling  
By U.S. Citizens



**WARNING**  
Cancer and Reproductive Harm -  
[www.P65Warnings.ca.gov](http://www.P65Warnings.ca.gov)

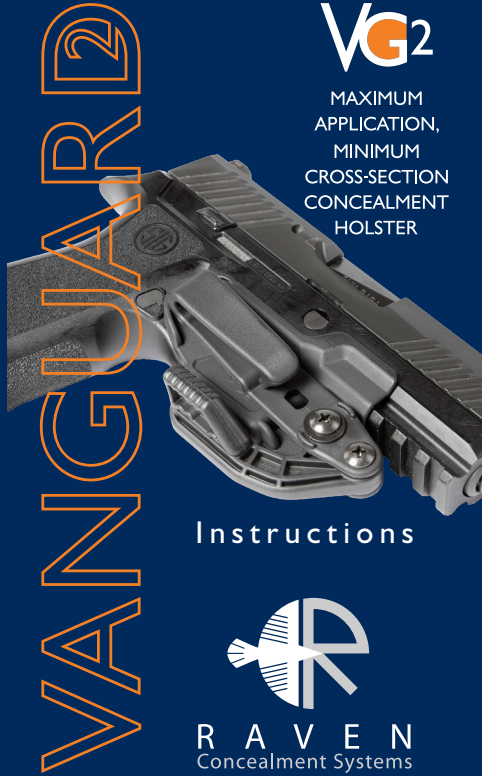

VG2  
MAXIMUM APPLICATION,  
MINIMUM CROSS-SECTION CONCEALMENT HOLSTER

VANGUARD 2

Instructions



# VANGUARD 2

The VanGuard 2 is a minimalist inside-the-waistband (IWB) holster. Unlike traditional IWB holsters, the VG2 covers only the trigger guard of the weapon. This unique design eliminates the bulk of a traditional holster, while providing a level of safety and security not attainable by simply sticking a pistol in the waistband of a pair of pants.

## Fit instructions

Due to variations in the frame and trigger guard dimensions from different production lots, the VG2 may fit differently on some weapons. For example, early Glock Gen 3 pistols may exhibit a little wiggle when the VG2 is installed, but it should still retain properly. To test the retention, install the VG2 on an unloaded weapon and hold the nose of the VG2. The VG2 should support the static weight of the weapon. **Do not shake the holstered weapon.** (Fig.1) Remember that the holster will be worn inside your waistband and the added pressure of your pants and belt will further tighten the retention of the holster and help prevent it from moving laterally, vertically and/or rotating.

### Installation of the VG2 on the weapon

Always follow the four basic firearms safety rules! Keep the weapon pointed in a safe direction and **ensure that nothing is inside or obstructing the trigger guard.** We recommend you install the VG2 on an unloaded weapon whenever possible.

Push the VG2 onto the trigger guard until it snaps into place around the trigger guard. (Fig. 2) You should hear and/or feel a positive "click" when the holster seats in place. If you do not (and your holster passed the above retention test) carefully remove the VG2 and attempt to identify a cause.

With the VG2 properly installed you can load the weapon if you will be working with a loaded weapon. Once again, follow all basic firearm safety rules.



Figure 1

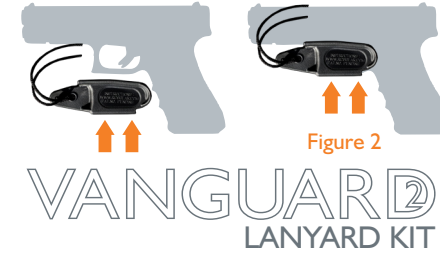

Figure 2

VANGUARD 2  
LANYARD KIT

## Use of the VG2 with lanyard deployment method

When setting up the VG2, always use an unloaded weapon to test the system until you've adjusted it to your preference.

The deployment lanyard can be configured in many ways. We prefer the lark's head knot method using one or both attachment holes. (Fig.3) This allows the lanyard to stay flat against the side of the VG2 when worn in the pants and allows for a shorter lanyard length to be used. To join the loose ends of the lanyard a square knot works well but an overhand or figure eight type knot can also be used. (Fig.4)

The lanyard can then be looped onto or secured to any solid object. This allows you to safely store a weapon with the trigger guard covered but allows rapid deployment and use of the firearm should the need arise.

To attach the VG2 to your belt, remove the pistol from the holster and stow it safely. Tuck the end of the lanyard loop behind the belt and pull until the loop is big enough to pass the holster through it. Then pull on the holster to tighten the lanyard to the belt. Do NOT attach the lanyard to a belt loop as the stitching may fail when the weapon is drawn. (Fig.5)

A note about belts: We recommend you use a strong, stiff belt that is designed for carrying a weapon. Every holster will work and conceal better when you use a belt that is designed to support the weight of a weapon and associated gear.

Once the VG2 is secured to the belt by the lanyard, install the holster on the weapon (see installation instructions). Insert the weapon inside the waistband of your pants. If the weapon sits too low, remove the VG2 and shorten the lanyard loop. If the weapon sits too high, remove the VG2 and lengthen the lanyard loop.

Once you have adjusted the lanyard to your preference you are ready to carry the weapon. Most users employ an untucked shirt as a cover garment, but if you prefer you can tuck your shirt in over the weapon and behind the lanyard for maximum concealment.

### Right hand application



Figure 3

### Left hand application



Figure 4



Figure 4



Figure 5

## Drawing the weapon

To draw the weapon, first clear any cover garment and establish a firm grip on the weapon. Be sure to keep your trigger finger straight along the frame or slide of the weapon as you draw. (Fig.6)

Pull straight up on the weapon until the lanyard reaches the end of its length and pulls the VG2 off of the weapon. (Fig.7) Then push the weapon straight out towards your target. (Fig.8)

If the lanyard does not pull the VG2 off of the weapon before you reach the limit of upward travel of your arm (around the pectoral muscle), you should shorten the length of the lanyard loop. You should not need to employ a "scooping"



Figure 6



Figure 7



Figure 8

draw stroke to deploy the VG2 where the holster does not deploy until you are extending the weapon towards the target. (Fig. 9)

Be aware that tall or sharp sights or extended/aftermarket controls on your weapon can possibly snag on your clothing. Make sure you have a firm grip on the weapon and no clothing is trapped by your hand against the weapon. If you encounter resistance that is greater than normal or feel clothing coming with the weapon STOP and determine what the problem is. As with any draw from any holster, if you lose your grip on the weapon DO NOT attempt to catch it. Let the weapon fall and retrieve it from the ground. Trying to catch a falling weapon is likely to result in an unintended discharge and is extremely dangerous.

**NEVER attempt to re-install the VG2 on the weapon while the holster is inside the waist band of your pants. Serious injury or death can occur if you attempt to reholster the weapon inside your waistband.**

To reholster the VG2 with the lanyard attached, keep the weapon pointed in a safe direction. With the hand that is not holding the weapon, get a hold of the holster that should be dangling from your belt. Once you have control of the holster, install the VG2 back on the weapon as described above.



Figure 9

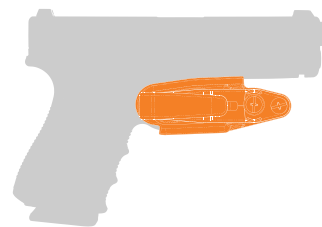

VANGUARD 2  
STANDARD KIT

## Use of the VG2 with overhook

The Vanguard 2 Standard Kit offers an option for users who prefer an easy on and off method of IWB carry. The overhook provides a durable yet secure solution with adjustable ride height and cant. The Standard kit is tuckable for maximum concealment and fully ambidextrous.

## Drawing the weapon

To draw the weapon, first clear any cover garment and establish a firm grip on the weapon. As you seat the grip, the attachment strut will naturally split your index and middle finger but should not impede you acquiring a full firing grip. (Fig. 11) Be sure to keep your trigger finger straight along the frame or slide of the weapon as you draw.

Once you have established your grip, use a firm committed draw as you normally would. If properly mounted, the holster will release the weapon and remain in your waistband attached to your belt. (Fig. 12)

Be aware that tall or sharp sights or extended/aftermarket controls on your weapon can possibly snag on your clothing. Make sure you have a firm grip on the weapon and no clothing is trapped by your hand against the weapon. If you encounter resistance that is greater than normal or feel clothing coming with the weapon STOP and determine what the problem is. As with any draw from



Figure 11



Figure 12



any holster, if you lose your grip on the weapon **DO NOT** attempt to catch it. Let the weapon fall and retrieve it from the ground. Trying to catch a falling weapon is likely to result in an unintended discharge and is extremely dangerous.

**NEVER attempt to reholster your weapon while the VG2 holster is inside your waistband. Attempting to reholster can result in serious injury or death.**

The VG2 is a carry holster. It is not meant as a training or range holster, nor is it suitable for those who may need to reholster their weapon with one hand. To "reholster" the VG2, secure the weapon in a safe manner or keep it pointed in a safe direction. Once the weapon is safely stowed or using your other hand, unsnap the VG2 from your belt and remove it from your waistband. Then repeat the above procedures to safely mount the holster in your waistband again.

## Ride Height

The Vanguard 2 can be configured for either high or low ride adjustments. In order to carry in the high-ride configuration, your VG2 should be left as is, and no height adjustment is needed. We do advise that you check the factory configuration is set as shown in (Fig.13) High-Ride.

In order to carry in the low-ride configuration, shift each screw up one hole in the pattern (Fig.14) Low-Ride, and reassemble using the exploded view provided as a guide (Fig.15).

\*Note ensure screws are tightened snugly once height configuration and Overhook cant are set.





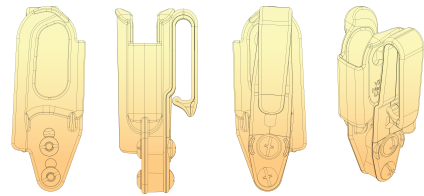

Figure 13

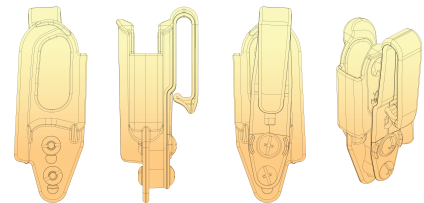

Figure 14

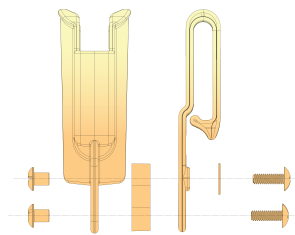

Figure 15



The new RCS Ambi Claw takes the Vanguard 2, an already established standard on minimalist carry, and adapted it to meet the requirements of present day carry concepts. Just like its predecessor, the Ambi Claw will rest under the belt line, leveraging the grip of the firearm into the body, enhancing its concealability. After analyzing how firearms rest and print based off positioning and body types, we produced a set of modules that can be installed based on the amount of lever the individual shooter requires.

Furthermore, the RCS Ambi Claw is now compatible across the Vanguard 2 product line, including our subcompact and slimline models. Minimal or aggressive lever depth, left or right handed, high and low ride options; the RCS Ambi Claw will provide a comfortable and effective IWB carry solution.

\*\* Compatible with the Vanguard 2 Tuckable Overhook and Soft Loop/Strut variants. \*\*



### Instructions

To install the Ambi Claw for right-handed shooters, follow the diagram Figure 16. For quick reference the posts will be inserted through the body side and the claw, overhook, washer, and screws will be inserted through the VG2 Logo (waistband facing) side. It's simply the inverse for left-handed shooters.

**Lever module Install** To install your lever module, refer to the diagram (Figure 17). For a less aggressive lever INTO the body, select module (B1) and push fit utilizing the snap hooks and respective slots in the "arm" of the claw. For a more aggressive lever, select part (B2).

**Lever Module Orientation** For those with larger hands that may experience binding or rubbing while achieving a firing grip at the apex of the grip module, you can invert the selected lever module and insert as shown in diagram (Figure 18) for more clearance.

**NOTE:** Lever module removal can best be done using a pair of needle nose pliers to apply light pressure to the snap hooks as they are pushed out of their slots.

**Ride Height Adjustment** The Ambi Claw can be adjusted for a high or low ride depending on the user's preference as shown in diagram (Figure 19). For a higher riding fitment, install marrying the hole patterns anchored off the Vanguard 2's lowest hole (C1). For a lower riding fitment, marry the hole patterns anchored off the Vanguard 2's highest hole (C2).

Figure 16

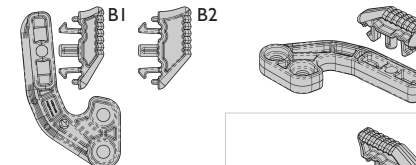
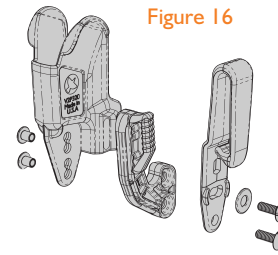

Figure 17

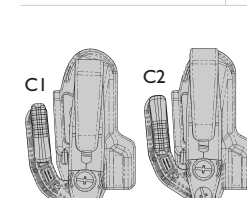

Figure 19

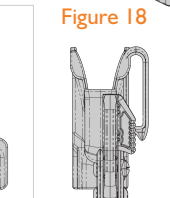

Figure 18

### Use of the VG2 with soft loop strut attachment method

Attaching the soft loop and strut to the VG2 holster

The soft loop has three mounting holes that can be used to adjust it to the width of your belt. It will fit 1.25", 1.5" and 1.75" belts. The soft loop uses a mil-spec Pull-the-Dot snap fastener. It is a directional snap and will only snap from the bottom up and unsnap from the top down. These snaps can be very stiff when new and may require some break in. If it is difficult to unsnap them, use a flat head screw driver or similar tool to lever the snaps open a few times until they break in.

The strut has three holes that the soft loop can be mounted to. This allows you to adjust the ride depth of the holster. You can also adjust the cant of the holster by rotating the soft loop prior to final tightening of the attachment screw. The dimples on the face of the attachment strut will prevent the soft loop from rotating once it is tightened down.

Use the supplied screw and slotted post nut to secure the strut to the VG2 holster body. For a right hand draw, attach the strut to the right face of the holster (the side with the RCS bird logo). Pay careful attention to how you install the hardware. (Fig. 20)

Incorrect assembly can cause damage to the system and/or possible failure.

Once you have configured the holster to your liking and tried it with an UNLOADED weapon, we recommend you apply a non-permanent thread locking compound to all the screws. Tighten the attachment strut to the holster by using a flat head and Phillips screwdriver on opposite sides and torque the hardware tight. Be sure and check the attachment hardware periodically to ensure it is tight.

Mounting the VG2 holster with strut on the belt

Be sure and practice this procedure with an unloaded

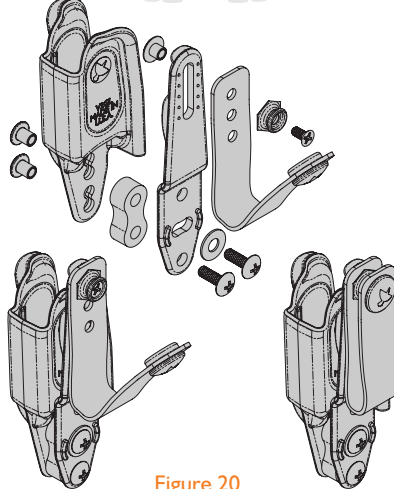

Figure 20

firearm before attempting to use the VG2 with a loaded weapon. The VG2 can be worn appendix/centerline or strong-side and has many adjustment options. Always use an unloaded firearm while you are experimenting with positioning the holster on your belt. We do NOT recommend using the VG2 in the small of the back carry (between 5:30 and 6:30 on the belt line). (Fig. 21)

Start by unsnapping the soft loop and then install the holster on the weapon (see installation instructions). If you will be carrying a loaded weapon, load the weapon at this time with the holster in place before attaching the holster to your belt.

Loosen your belt slightly and slip the holstered weapon into your waistband while guiding the soft loop behind the belt. Pull the soft loop up and snap it around the belt. Then tighten the belt. A note about belts: We recommend you use a strong, stiff belt that is designed for carrying a weapon. Every holster will work and conceal better when you use a belt that is designed to support the weight of a weapon and associated gear.

Most users employ an untucked shirt as a cover garment, but if you prefer you can tuck your shirt in over the weapon and behind the strut for maximum concealment. (Fig. 22)

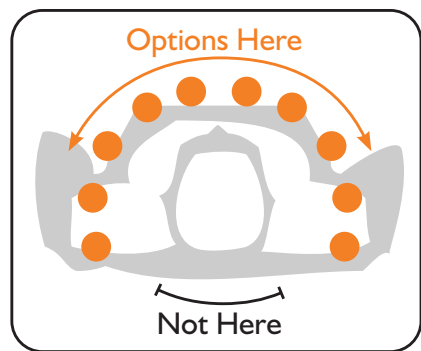

Figure 21



Figure 22

### Pull-the-Dot™ Snap Instructions

We use Mil-Spec, Pull-the-Dot snap fasteners on our soft loops. These are directional snaps and will only open or close in a certain direction. This feature prevents the snaps from opening when the being worn on the belt, but will allow you to unsnap them easily to remove the holster. These snaps can be very difficult to open and/or close when new and may require a break in period. The following instructions will help you use the snaps and trouble shoot some common issues we've found with new snaps.

Pull-the-Dot snaps are directional. They will only snap by hooking the bottom of the female socket on the male snap and rolling up. To un-snap, apply outward pressure on the top edge of the female socket (where the dot is on the cap) and it will release from the male snap. (Fig. 23)

If you can not open the snaps by hand when new, use a flathead screw driver or similar tool and place it between the female socket and male snap at the top of the snap (where the dot is on the cap). Twist the screwdriver and the two halves should separate easily. Once un-snapped, ensure the screw in the male side is tight. Repeat this process until the two can be easily un-snapped by hand. A drop of oil on the male snap can also help. (Fig. 24)

If it is very difficult to close the snap by hand when new, first make sure the screw in the male snap is tight. Then, look inside the female cap. There is a ring of metal around the inside of the cap. There is a split in this ring (Fig. 25). The sharp edges of this split can bind on the male snap and prevent you from closing the snap. Using a flathead screwdriver or similar tool, rotate the split around until it is next to the metal band that holds the ring in the cap (Fig. 26). Once the split is in this position, you should be able to close the snap by hand.



Figure 23



Figure 24

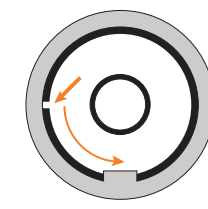

Figure 25

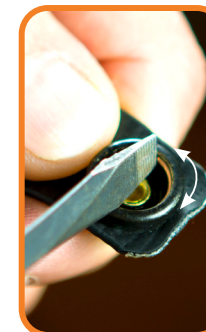

Figure 26

### The four basic firearm safety rules:

1. Treat all guns as if they are loaded
2. Keep your fingers outside of the trigger guard until you are ready to fire
3. Never let the muzzle cross anything you are not willing to kill, destroy, or purchase.
4. Always know your target, its foreground and background.

